

# Rear differential skid plate

## Mounting instructions for Subaru Forester and XV

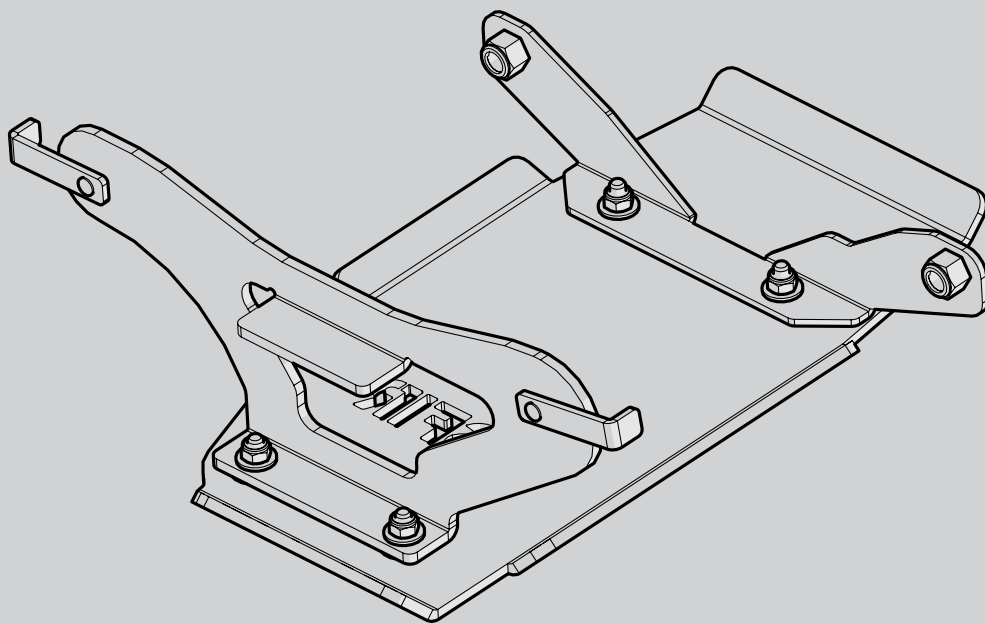

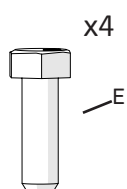
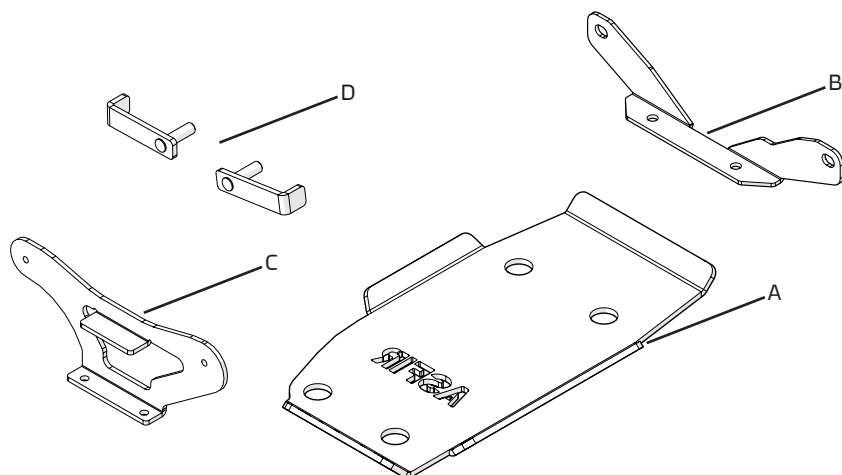

Hex bolt  
M8x25

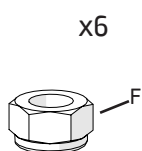

Hex nut nylock  
M8

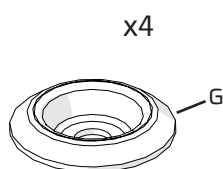

Pocket washer 8

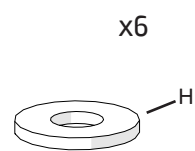

Washer 8x20

### Maximum Tightening Torques

M8(8.8)	25Nm
M12x1.25	110 Nm

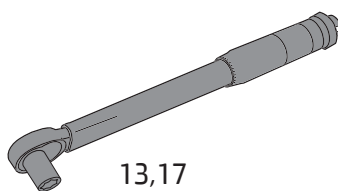

13,17



13,17



Thread lockers  
glue

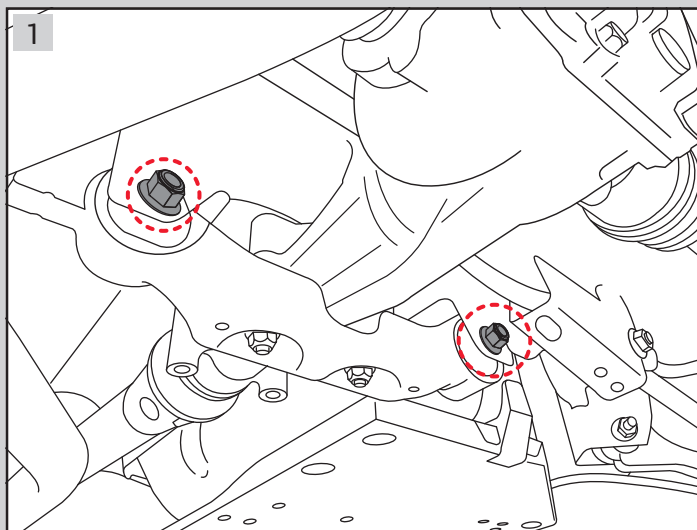

Release the marked nuts and save them for the next step

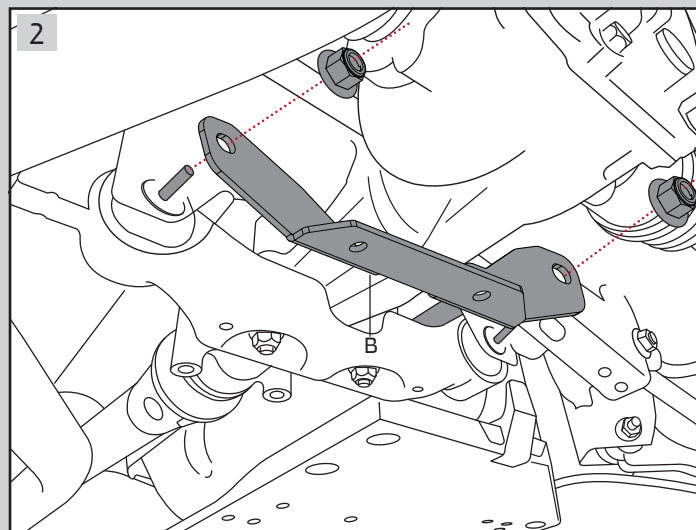
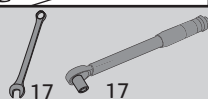

Use original nuts and thread lockers glue to connect bracket B into the vehicle chassis

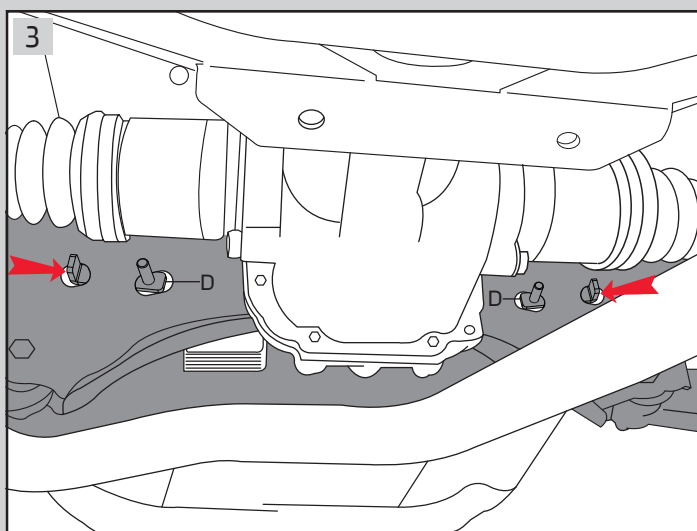
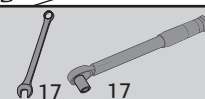

Insert bolts D into the chassis as shown above

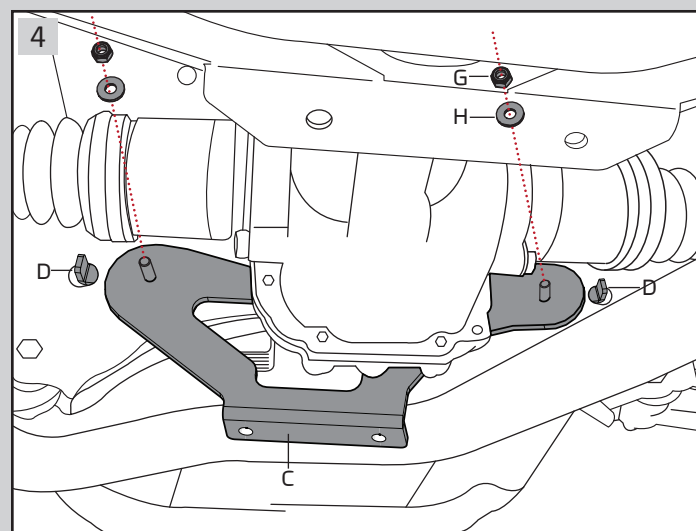

Connect bracket C to the vehicle chassis as shown above

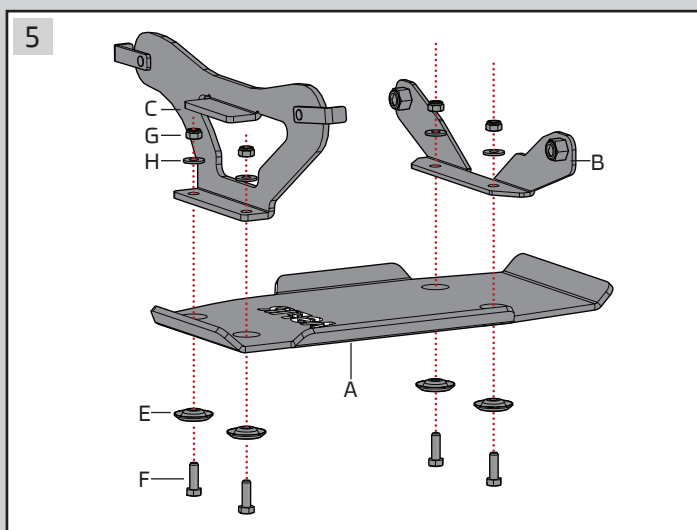
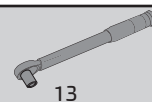

Connect skid plate A to the brackets as shown above

