

# Front skid plate

## Mounting instructions

### for Subaru Forester

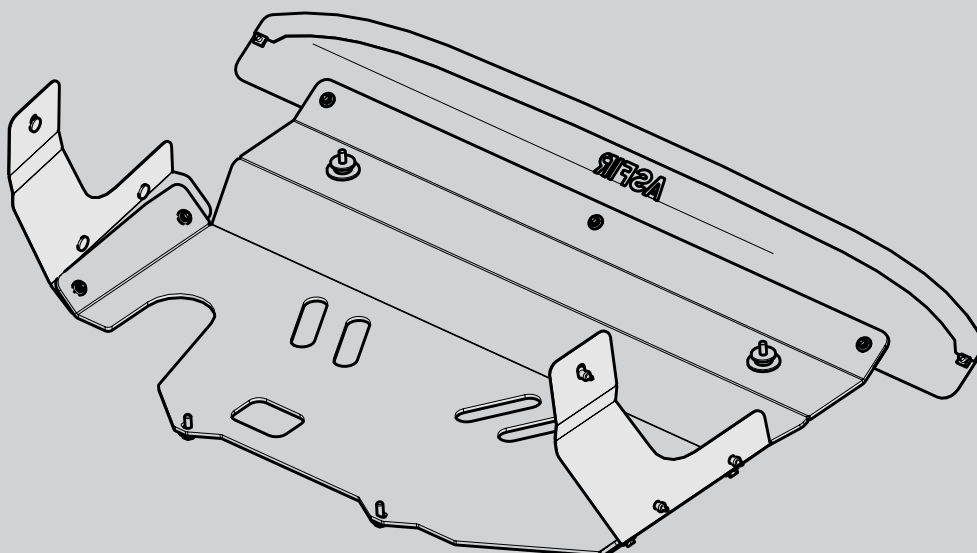

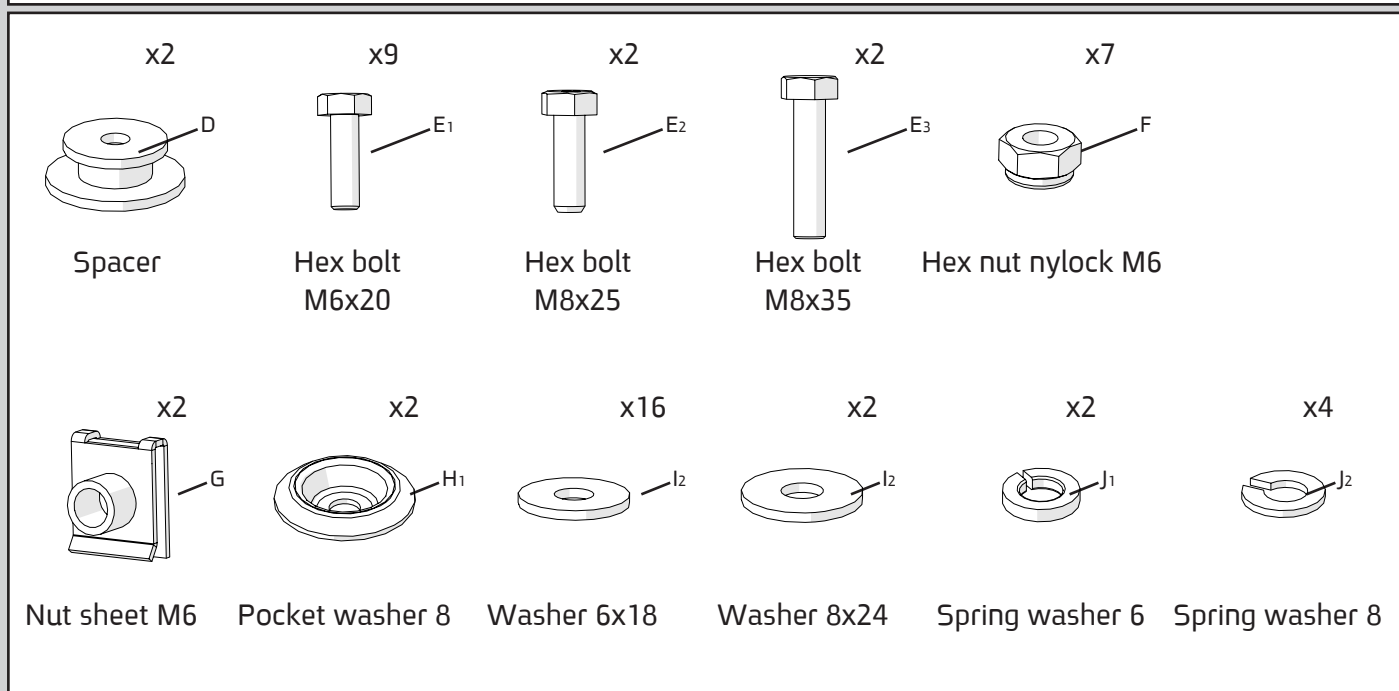
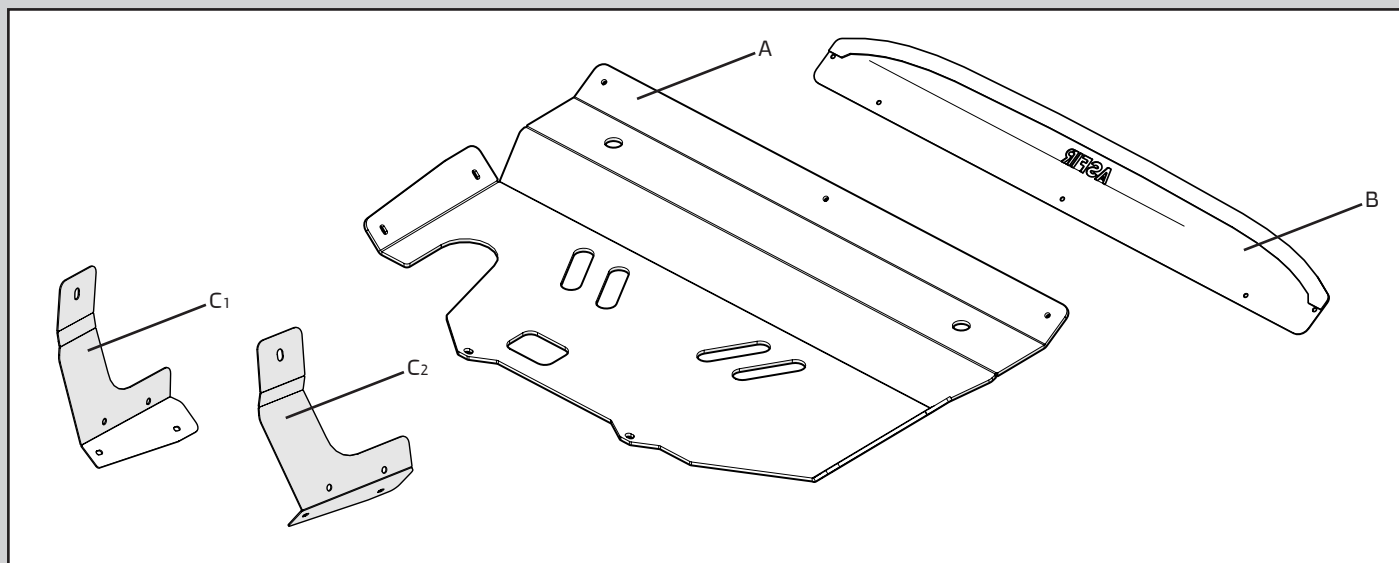

### Maximum Tightening Torques

M6	10 Nm
M8(8.8)	25Nm

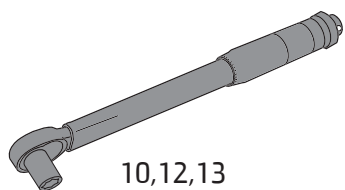

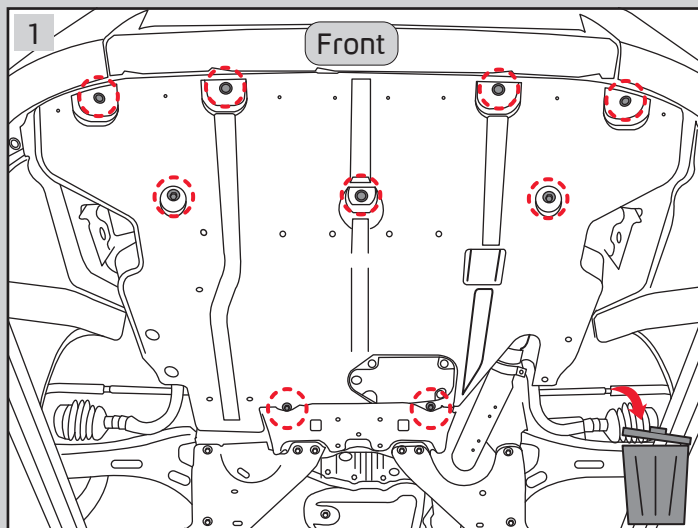

Disconnect 5 clips and 4 bolts shown above.  
Reattach the 4 front clips to the bumper

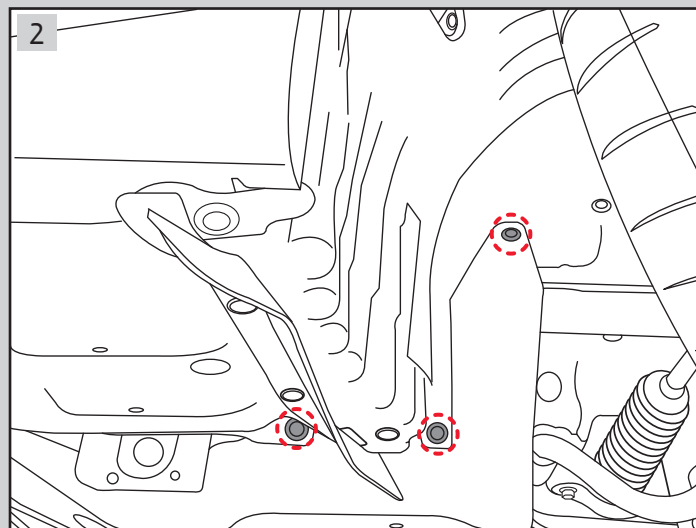
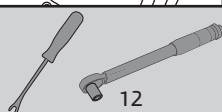

Disconnect 3 clips and Save them for later

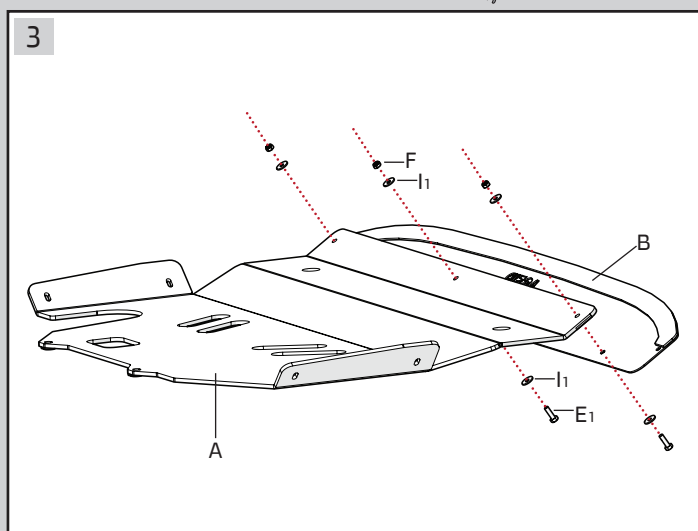

Connect plate B to skid plate A

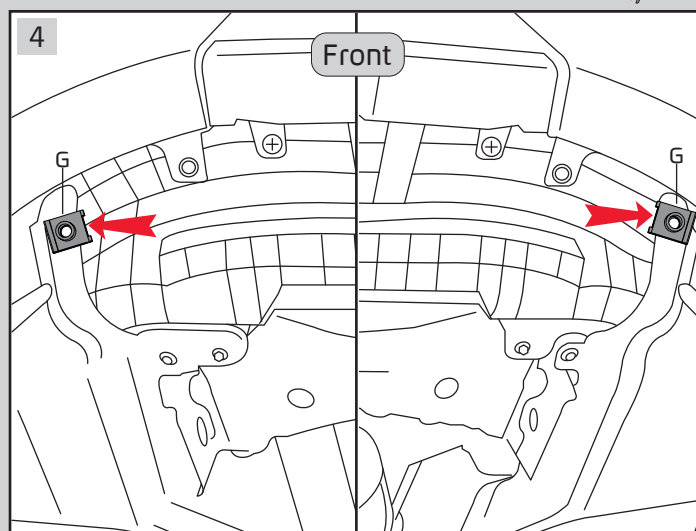
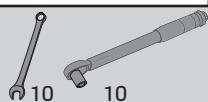

Align the nut holes to the car chassis holes

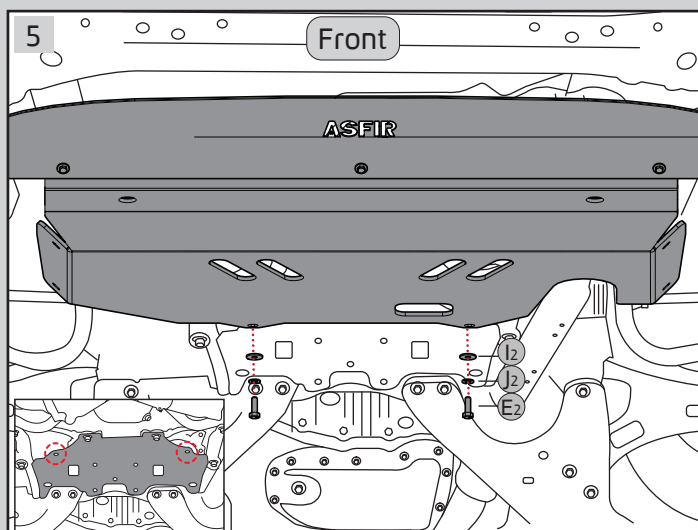

Screw bolts into original holes circled in red  
in the small picture

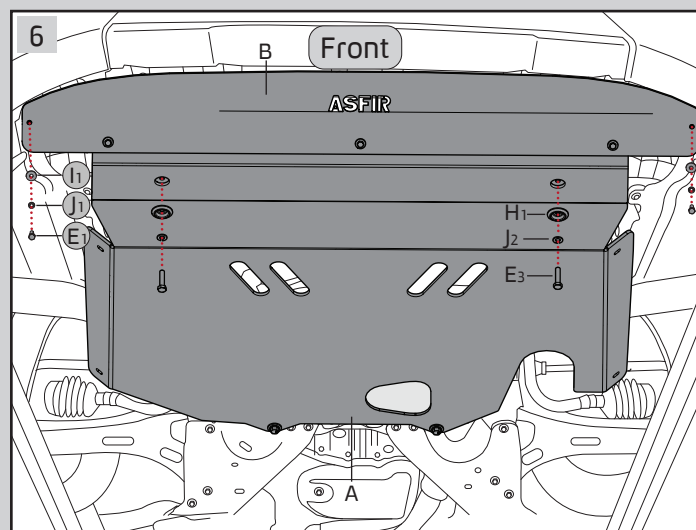
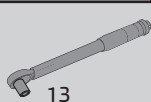

Connect skid plate A to original screwings and plate B  
to nut G as shown above

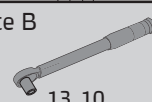

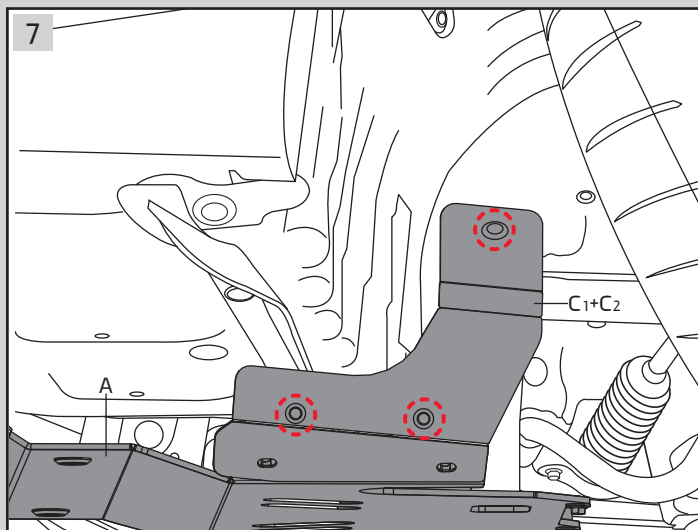

Connect brackets C<sub>1</sub> and C<sub>2</sub> to the vehicle chassis on both sides of the vehicle with the 3 clips from step 1

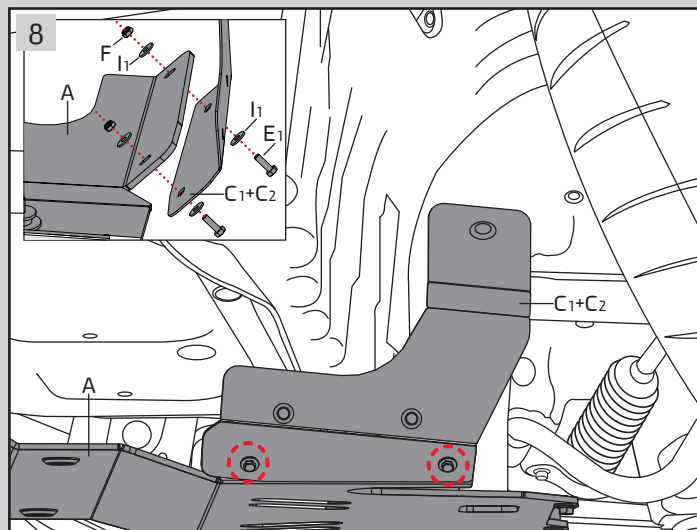

Tighten brackets C<sub>1</sub> and C<sub>2</sub> as shown above

