

Fuel tank skid plate

Mounting instructions

for Toyota Land Cruiser 150 / 4Runner & Lexus GX460

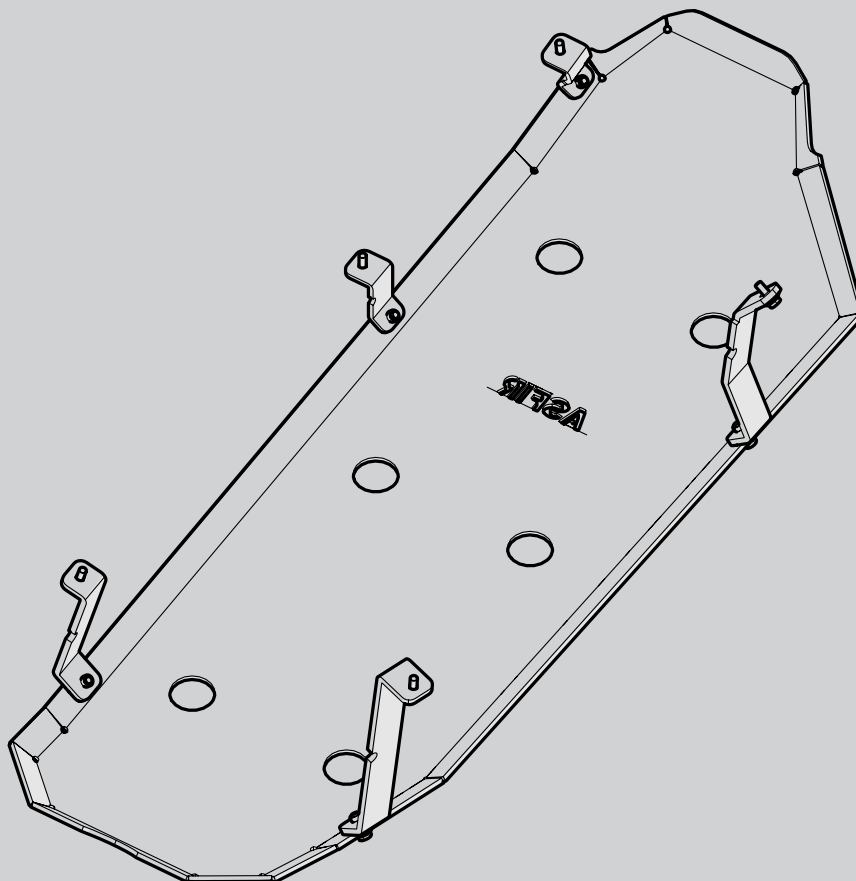

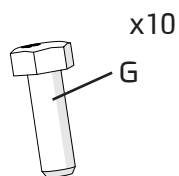
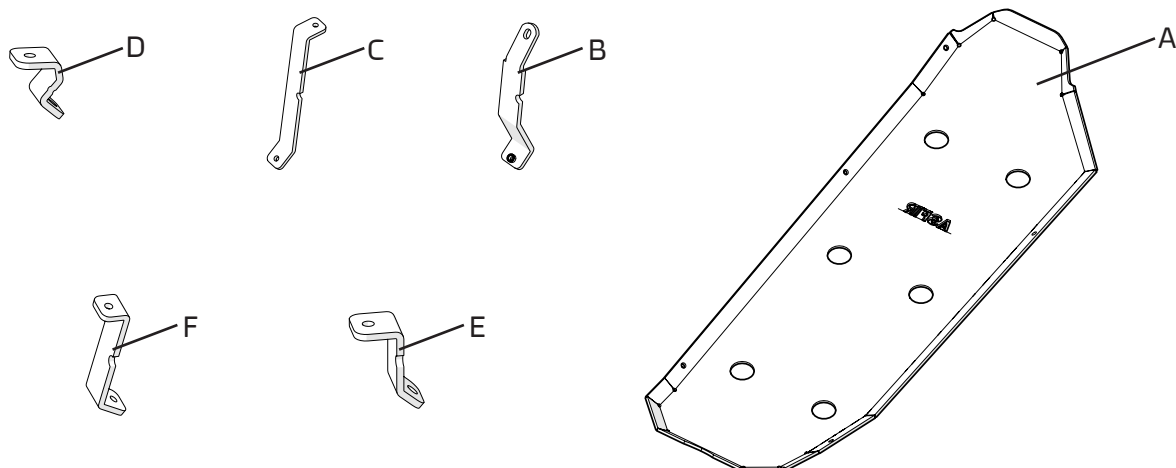

Hex bolt M8x25

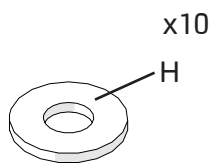

Washer 8x20

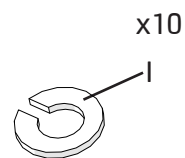

Spring washer 8

Maximum Tightening Torques

M8 (8.8)

25 Nm

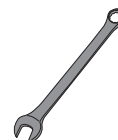
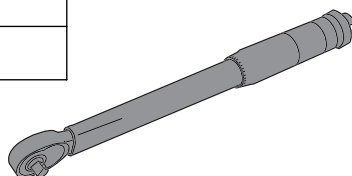

12



12,13

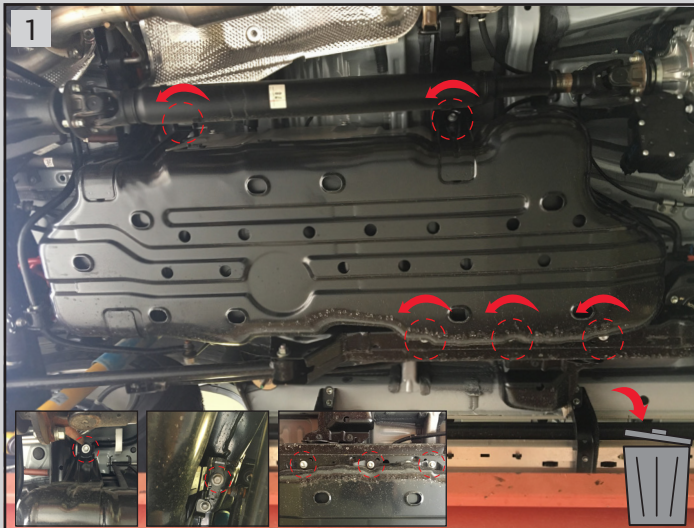

Open 5 bolts of the fuel tank plate, remove the plate and dispose it.

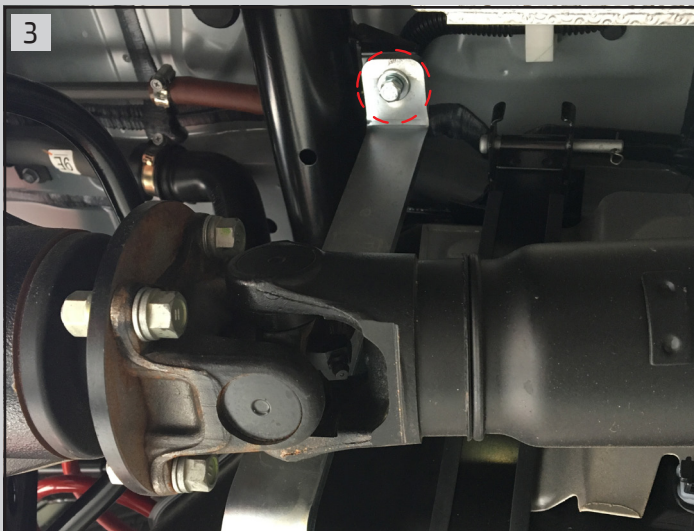
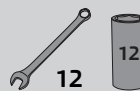

Place bracket (C) and connect it to the original screwing using hex bolt (G), washer (H) and spring washer (I)



Place bracket (E) and connect it to the original screwing using hex bolt (G), washer (H) and spring washer (I)



Place bracket (B) and connect it to the original screwing using hex bolt (G), washer (H) and spring washer (I)



Place bracket (F) and connect it to the original screwing using hex bolt (G), washer (H) and spring washer (I)



Place bracket (D) and connect it to the original screwing using hex bolt (G), washer (H) and spring washer (I)





Place plate (A) and connect it to brackets (B,C,F,D,E) using hex bolt (G), washer (H) and spring washer (I). Tighten all 5 bolts